

ZKLFA0630-2Z

Axial angular contact ball bearing

Schaeffler ID:
0001288990000

Angular contact ball bearing units
ZKLFA...-2Z, double direction, for screw
mounting, gap seals on both sides

Technical information

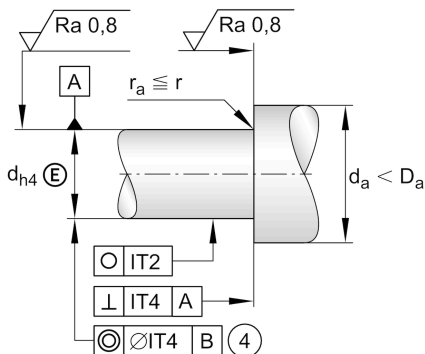
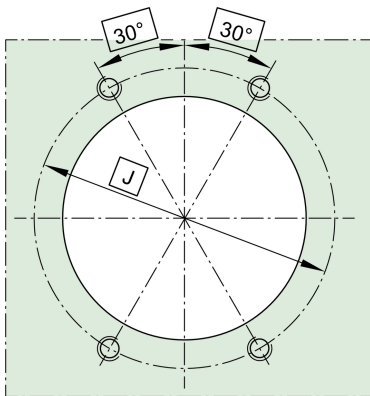
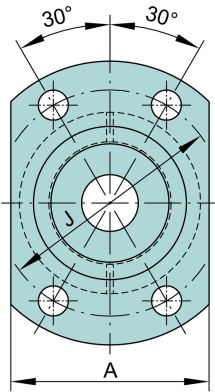

Main Dimensions & Performance Data

d	6 mm	Bore diameter
	0,002 mm	Bore diameter upper tolerance
	-0,003 mm	Bore diameter lower tolerance
D	19 mm	Outside diameter
	0 mm	Outside diameter upper tolerance
	-0,01 mm	Outside diameter lower tolerance
B	12 mm	Width
	0 mm	Width upper tolerance
	-0,25 mm	Width lower tolerance
C _a	4.550 N	Basic dynamic load rating, axial
C _{0a}	5.700 N	Basic static load rating, axial
C _{ua}	260 N	Fatigue load limit, axial
n _{G Grease}	22.800 1/min	Limiting speed for grease lubrication
n _g	14.000 1/min	Thermally permissible speed
≈m	38,5 g	Weight

Mounting dimensions

d _{a min}	9 mm	Minimum diameter shaft shoulder
d _{a max}	15 mm	Maximum diameter of shaft shoulder
t ₁	0,1 mm	position tolerance
	M3	Screw size
n _a	4	Number of screws

Dimensions

d ₁	12 mm	Rib diameter inner ring
r _{min}	0,3 mm	Minimum chamfer dimension
r _{1 min}	0,3 mm	Minimum chamfer dimension
B ₁	5 mm	Thickness of flange
d ₂	3,5 mm	Fixing boring diameter
J	24 mm	Pitch circle diameter (holes)
A	22 mm	Flange width

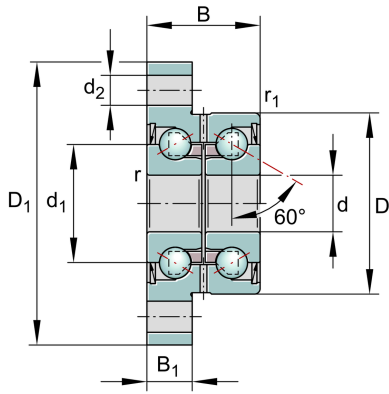

Temperature range

T_{min}	-30 °C	Operating temperature min.
T_{max}	120 °C	Operating temperature max.

Additional information

M_{RL}	0,01 Nm	Bearing friction torque
c_{aL}	150 N/μm	Rigidity axial
c_{kL}	4 Nm/mrad	Tilting stiffness
M_m	0,0019 kg*cm ²	Mass moment of inertia
	2 μm	Axial runout
	ZM06	recommended INA precision locknut for radial locking (not included)
M_A	2 Nm	Tightening torque nut
	2.010 N	Locknut force axial

