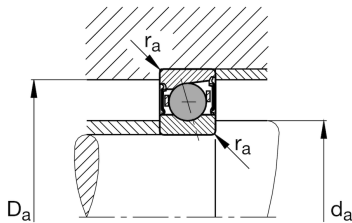
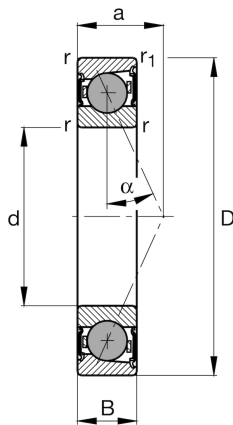
**FAG****HCS7003-E-T-P4S-UL**

Angular contact ball bearing

Spindle bearings HCS70..-E, adjusted, in pairs or sets, contact angle $\alpha = 25^\circ$, with ceramic balls, lip seals on both sides, non-contact, restricted tolerances

Technical information

**Main Dimensions & Performance Data**

d	17 mm	Bore diameter
D	35 mm	Outside diameter
B	10 mm	Width
C_r	3.350 N	Basic dynamic load rating, radial
C_{0r}	1.460 N	Basic static load rating, radial
C_{ur}	117 N	Fatigue load limit, radial
$n_{G \text{ Grease}}$	75.000 1/min	Limiting speed for grease lubrication
$\approx m$	45 g	Weight

Mounting dimensions

d_a	21 mm	Diameter shaft shoulder
d_a	h12	Diameter shaft shoulder clearance
D_a	32 mm	Shoulder diameter outer ring
D_a	H12	Shoulder diameter outer ring clearance
$r_{a \text{ max}}$	0,3 mm	Maximum recess radius
$r_{a1 \text{ max}}$	0,1 mm	Maximum recess radius
a	11,1 mm	Distance between the apexes of the pressure cones

Dimensions

r_{min}	0,3 mm	Minimum chamfer dimension
$r_{1 \text{ min}}$	0,3 mm	Minimum chamfer dimension
α	25 °	Contact angle

Temperature range

T_{min}	-30 °C	Operating temperature min.
T_{max}	80 °C	Operating temperature max.



View product details on medias

21.05.2024, 16:30:45 CEST

SCHAEFFLER

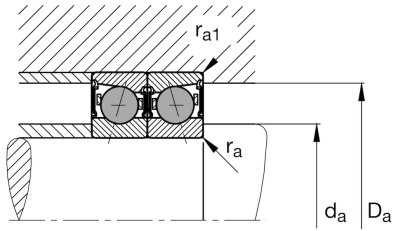

Additional information

F_{VL}	14 N	Preload force light
F_{VM}	43 N	Preload force medium
F_{VH}	86 N	Preload force heavy
K_{aEL}	41 N	Lift-off force light
K_{aEM}	126 N	Lift-off force medium
K_{aEH}	256 N	Lift-off force heavy
c_{aL}	35 N/ μm	Axial rigidity light
c_{aM}	52 N/ μm	Axial rigidity medium
c_{aH}	68 N/ μm	Axial rigidity heavy