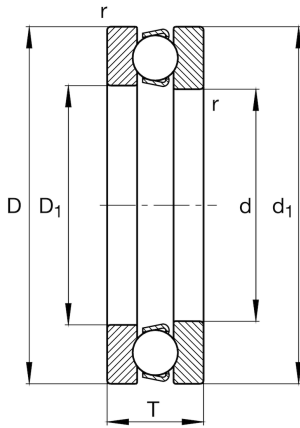

**FAG****51108**

Axial deep groove ball bearing

Axial deep groove ball bearing 511, single direction, steel sheet metal cage

## Technical information

**Main Dimensions & Performance Data**

d	40 mm	Inner diameter shaft washer
D	60 mm	Outer diameter housing washer
T	13 mm	Height
$C_a$	25.500 N	Basic dynamic load rating, axial
$C_{0a}$	62.000 N	Basic static load rating, axial
$C_{ua}$	2.850 N	Fatigue load limit, axial
$n_G$	7.400 1/min	Limiting speed
$n_{gr}$	6.400 1/min	Reference speed
$\approx m$	119 g	Weight

**Mounting dimensions**

$d_{a \min}$	52 mm	Minimum diameter shaft shoulder
$D_{a \max}$	48 mm	Maximum diameter of housing shoulder
$r_{a \max}$	0,6 mm	Maximum filled radius

**Dimensions**

$r_{\min}$	0,6 mm	Minimum chamfer dimension
$D_1$	42 mm	Inner diameter housing washer
$d_1$	60 mm	Outer diameter shaft washer

**Temperature range**

$T_{\min}$	-30 °C	Operating temperature min.
$T_{\max}$	150 °C	Operating temperature max.

**Calculation factors**

A	0,02	Minimum load factor
---	------	---------------------