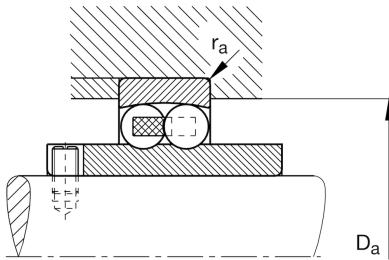
**FAG****11212-TVH**

Self-aligning ball bearing

Self-aligning ball bearing 112..-TVH, plastic cage

Technical information

**Main Dimensions & Performance Data**

d	60 mm	Bore diameter
D	110 mm	Outside diameter
B	22 mm	Width, outer ring
B _i	62 mm	Width, inner ring
C _r	30.500 N	Basic dynamic load rating, radial
C _{0r}	11.500 N	Basic static load rating, radial
C _{ur}	730 N	Fatigue load limit, radial
n _G	6.900 1/min	Limiting speed
n _{gr}	6.300 1/min	Reference speed
≈m	1,54 kg	Weight

Mounting dimensions

D _{a max}	101 mm	Maximum diameter of housing shoulder
r _{a max}	1,5 mm	Maximaler Hohlkehlradius

Dimensions

r _{min}	1,5 mm	Minimum chamfer dimension
D ₁	95,16 mm	Shoulder diameter outer ring
d ₁	78 mm	Shoulder diameter inner ring
b	7 mm	Width retaining slot
t	9 mm	Hight retaining slot

Temperature range

T _{min}	-30 °C	Operating temperature min.
T _{max}	120 °C	Operating temperature max.

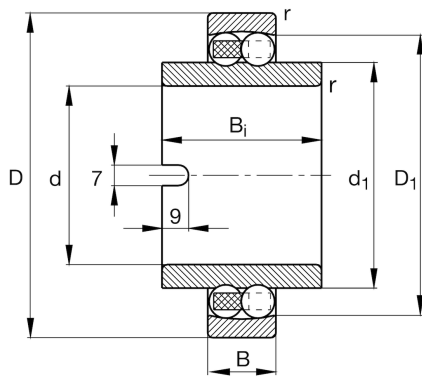



[View product details on medias](#)

22.04.2024, 16:08:46 CEST

SCHAEFFLER

Calculation factors

e	0,18	Limiting value of Fa/Fr for the applicability of diff. Values of factors X and Y
Y ₁	3,47	Dynamic axial load factor
Y ₂	5,37	Dynamic axial load factor
Y ₀	3,64	Static axial load factor