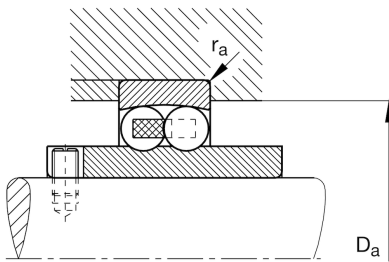
**FAG****11210-TVH**

Self-aligning ball bearing

Self-aligning ball bearing 112...TVH, plastic cage

Technical information

**Main Dimensions & Performance Data**

d	50 mm	Bore diameter
D	90 mm	Outside diameter
B	20 mm	Width, outer ring
B _i	58 mm	Width, inner ring
C _r	22.900 N	Basic dynamic load rating, radial
C _{0r}	8.100 N	Basic static load rating, radial
C _{ur}	520 N	Fatigue load limit, radial
n _G	8.700 1/min	Limiting speed
n _{gr}	7.700 1/min	Reference speed
≈m	0,85 kg	Weight

Mounting dimensions

D _{a max}	83 mm	Maximum diameter of housing shoulder
r _{a max}	1 mm	Maximaler Hohlkehlradius

Dimensions

r _{min}	1,1 mm	Minimum chamfer dimension
D ₁	77,13 mm	Shoulder diameter outer ring
d ₁	62,7 mm	Shoulder diameter inner ring
b	7 mm	Width retaining slot
t	9 mm	Hight retaining slot

Temperature range

T _{min}	-30 °C	Operating temperature min.
T _{max}	120 °C	Operating temperature max.

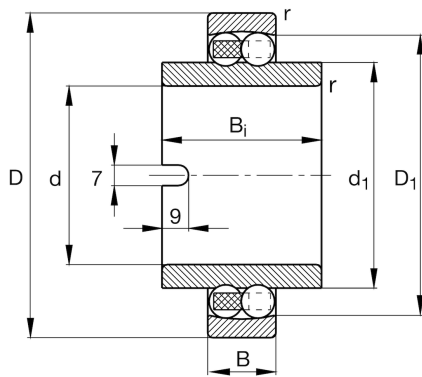



[View product details on medias](#)

22.04.2024, 16:06:17 CEST

SCHAEFFLER

Calculation factors

e	0,2	Limiting value of Fa/Fr for the applicability of diff. Values of factors X and Y
Y ₁	3,15	Dynamic axial load factor
Y ₂	4,87	Dynamic axial load factor
Y ₀	3,3	Static axial load factor