

FAG

**11205-TVH**

Self-aligning ball bearing

Self-aligning ball bearing 112...TVH, plastic cage

## Technical information

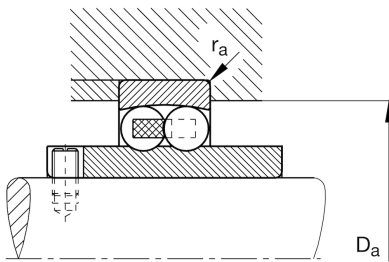
**Main Dimensions & Performance Data**

d	25 mm	Bore diameter
D	52 mm	Outside diameter
B	15 mm	Width, outer ring
B <sub>i</sub>	44 mm	Width, inner ring
C <sub>r</sub>	12.300 N	Basic dynamic load rating, radial
C <sub>0r</sub>	3.300 N	Basic static load rating, radial
C <sub>ur</sub>	209 N	Fatigue load limit, radial
n <sub>G</sub>	15.500 1/min	Limiting speed
n <sub>gr</sub>	13.400 1/min	Reference speed
≈m	0,221 kg	Weight

**Mounting dimensions**

D <sub>a max</sub>	46,4 mm	Maximum diameter of housing shoulder
r <sub>a max</sub>	1 mm	Maximaler Hohlkehlradius

**Dimensions**

r <sub>min</sub>	1 mm	Minimum chamfer dimension
D <sub>1</sub>	43,6 mm	Shoulder diameter outer ring
d <sub>1</sub>	33,3 mm	Shoulder diameter inner ring
b	7 mm	Width retaining slot
t	9 mm	Hight retaining slot

**Temperature range**

T <sub>min</sub>	-30 °C	Operating temperature min.
T <sub>max</sub>	120 °C	Operating temperature max.

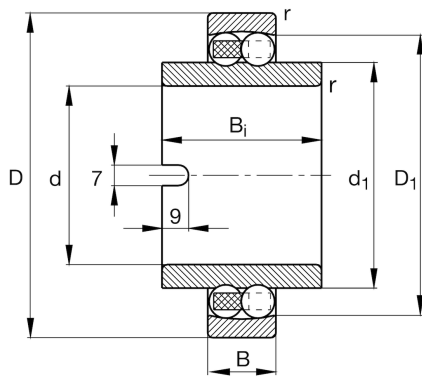



[View product details on medias](#)

22.04.2024, 16:00:33 CEST

**SCHAEFFLER**

### Calculation factors

e	0,27	Limiting value of Fa/Fr for the applicability of diff. Values of factors X and Y
Y <sub>1</sub>	2,36	Dynamic axial load factor
Y <sub>2</sub>	3,65	Dynamic axial load factor
Y <sub>0</sub>	2,47	Static axial load factor