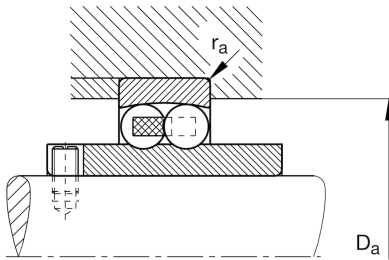
**FAG****11204-TVH**

Self-aligning ball bearing

Self-aligning ball bearing 112...-TVH, plastic cage

Technical information

**Main Dimensions & Performance Data**

d	20 mm	Bore diameter
D	47 mm	Outside diameter
B	14 mm	Width, outer ring
B _i	40 mm	Width, inner ring
C _r	10.100 N	Basic dynamic load rating, radial
C _{0r}	2.600 N	Basic static load rating, radial
C _{ur}	166 N	Fatigue load limit, radial
n _G	18.100 1/min	Limiting speed
n _{gr}	15.300 1/min	Reference speed
≈m	0,186 kg	Weight

Mounting dimensions

D _{a max}	41,4 mm	Maximum diameter of housing shoulder
r _{a max}	1 mm	Maximaler Hohlkehlradius

Dimensions

r _{min}	1 mm	Minimum chamfer dimension
D ₁	37,75 mm	Shoulder diameter outer ring
d ₁	29,2 mm	Shoulder diameter inner ring
b	7 mm	Width retaining slot
t	9 mm	Hight retaining slot

Temperature range

T _{min}	-30 °C	Operating temperature min.
T _{max}	120 °C	Operating temperature max.

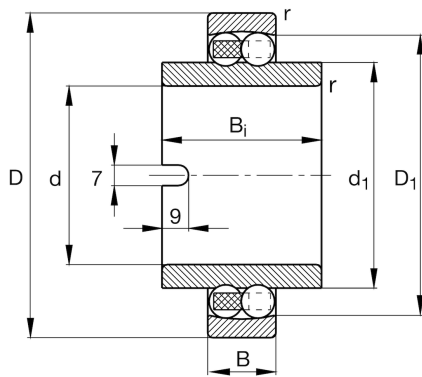



[View product details on medias](#)

22.04.2024, 15:58:34 CEST

SCHAEFFLER

Calculation factors

e	0,28	Limiting value of Fa/Fr for the applicability of diff. Values of factors X and Y
Y ₁	2,24	Dynamic axial load factor
Y ₂	3,47	Dynamic axial load factor
Y ₀	2,35	Static axial load factor